

Client:

Job Title:

Products Protecta FR IPT Sealant

Application Fire rated, water proof and movement linear seals in flexible walls

Construction Minimum wall thickness of 64mm and comprise steel studs or timber studs lined on both faces with minimum 1 layer of 12.5 mm thick board.

Installation Instructions

1. All surfaces must be clean and sound, free from dirt, grease and other contaminants. The surfaces may be damp but not running wet. Use a wet brush to clean surfaces before application to remove loose material and to ensure good contact for adhesion. Primers are not usually required.
2. Cut nozzle to the desired angle and gun firmly into the joint to give a good solid fill. Strike off the sealant flush with the joint sides within ten minutes of application, before surface skinning occurs. The sealant will have low shrinkage during cure and if a flush surface it is recommended to leave the sealant proud.
3. Protecta® FR IPT can be tooled to a smooth finish using a moist plastic stick or similar within 30 minutes of application. IPT Tooling designed for the optimum finish is recommended instead of soap and water as it forms a film between the stick and the sealant.
4. Do not spray the sealant with water or other fluids before skin formation (<30 min). Uncured sealant is soluble in water prior to skinning due to its environmentally friendly IPT chemistry that uses water instead of solvents.
5. Protecta® FR IPT can be over-painted with most emulsion or alkyd (gloss) paints.

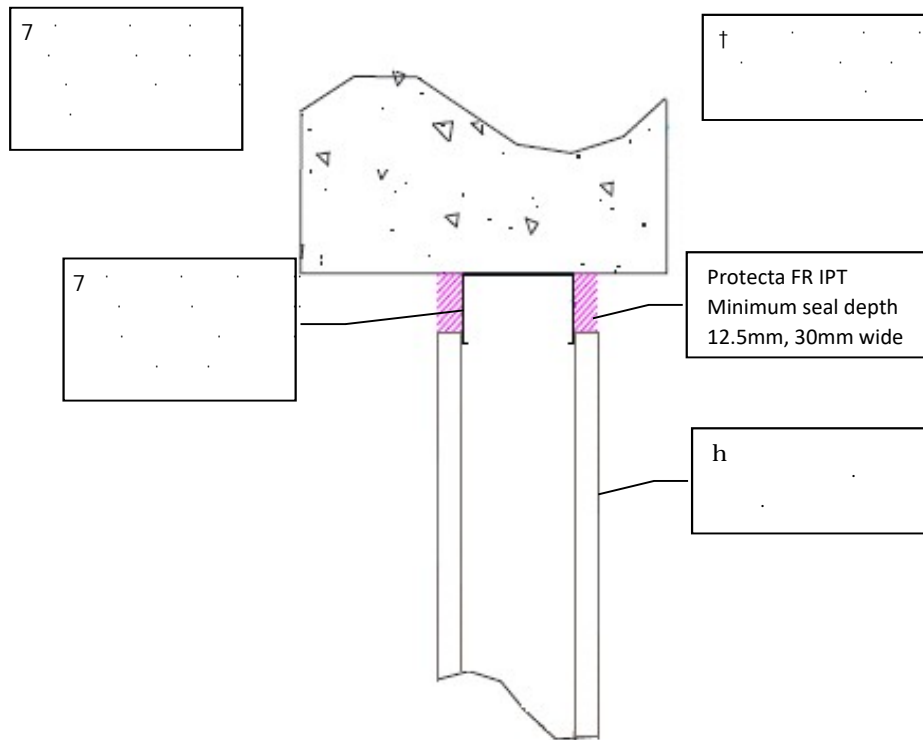

IPT sealant 12.5mm each side, max width 30mm
 Seismic Tensile elongation 270%
 3D tensile elongation 106%
 Sound reduction (seal only) STC 62



UL (UK) Ltd
 4788415167
 AS1530.4-2014

ETA 14/0041

As a part of our policy of on-going product development and testing, we reserve the right to modify, alter or change product specifications without giving notice. All information contained in this document is given in good faith and is provided for guidance only. Any drawings provided are for illustrative purposes only. As Polyseam has no control over the methods or competence of installation and of prevailing site conditions, no warranties, expressed or implied, is intended to be given as to the actual performance of the product mentioned or referred to herein and no liability whatsoever will be accepted for any loss, damage or injury arising from the use of the information given.

For all technical details on the products specified please refer to the technical data sheets that can be found on www.firestopcentre.co.nz

Signed and approved:

Email: post.uk@polyseam.com
 Sheet size: **A4**
 Drawn date & no: **8/4/18**
 Scale: **NTS**
 Drawn by: **K.B**